

KIAORA PLACE



Anchored by Woolworths, Dan Murphy's and NAB, Kiaora Place offers destination shopping, dining and professional services to the local community.

3km East of Sydney CBD, Kiaora Place is one of the most vibrant and recognisable cosmopolitan retail precinct of Sydney, straddling the arterial route of New South Head Road.

KEY CENTRE FACTS

POPULATION WITHIN 4KM RADIUS

 **235,206**
2021 IQ CENSUS

GLA

 **5,886** M²

RETAILERS

 **18**

PARKING SPACES

 **440+**

LOCATION MAP

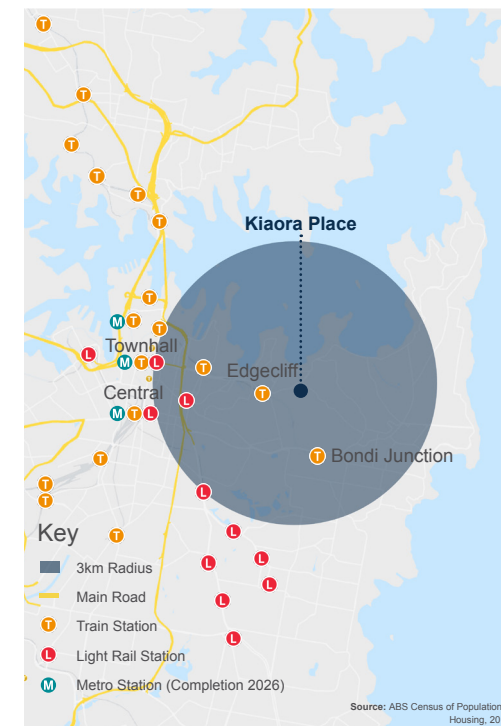

ADAM SHEUMACK

0411 287 869

adams@rookpartners.com



CENTRE PLAN - GROUND FLOOR

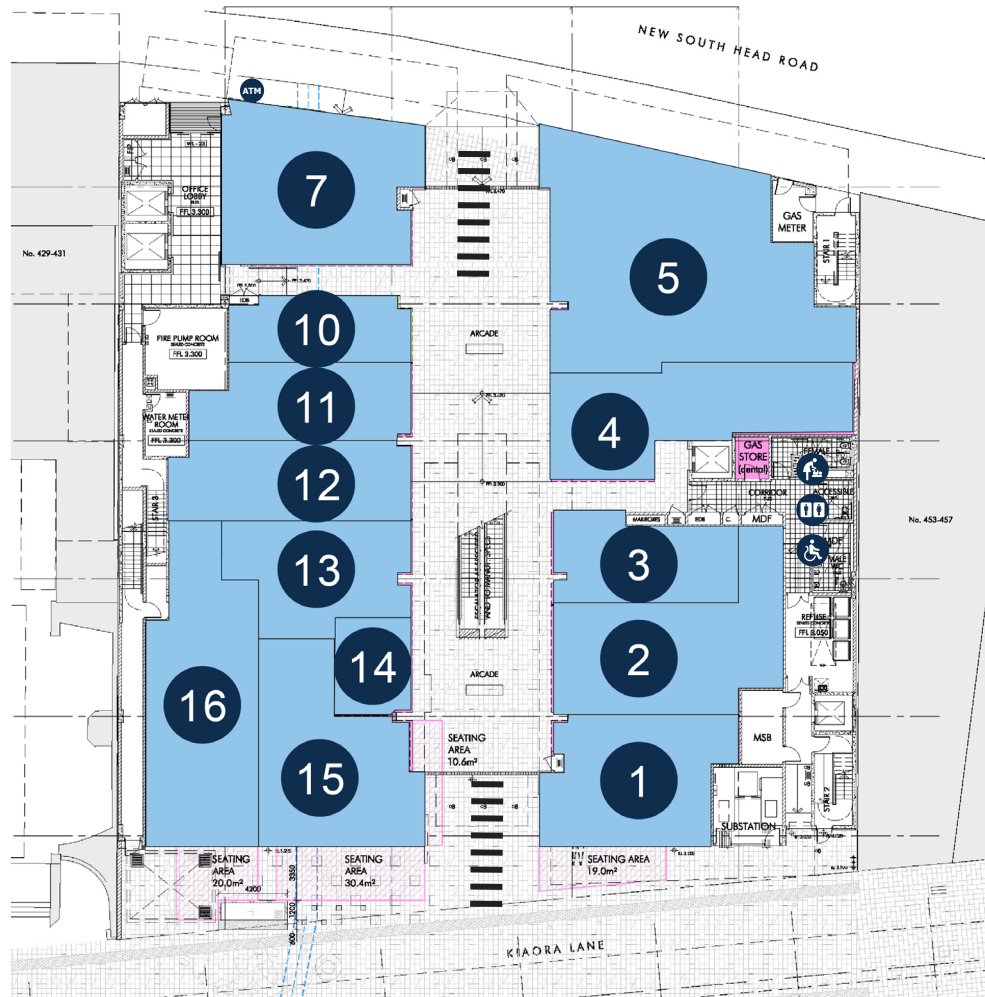

Tenancies

1	White Rabbit	84m ²
2	Sushi Maru	104m ²
3	Maison DB	59m ²
4	Zjoosh	96m ²
6	NAB	205m ²
7	Laser Clinics Australia	99m ²
10	The Salon	43m ²
11	Bladez & Co	61m ²
12	Le Nails	68m ²
13	Naked Foods	70m ²
14	Cali Press	28m ²
15	Bake Bar	101m ²
16	Yo-Chi	120m ²

Key

	Major		Main Entry
	Specialty		
	Leasing Opportunity		